

FORM

FOR LEASE

ALEXANDRA
DAVIE & BIDWELL STREET
VANCOUVER, BC



JACK ALLPRESS*
604 638 1975
jallpress@formretail.ca

MICHAEL HECK
604 398 4379
mheck@formretail.ca

*Personal Real Estate Corporation

FOR LEASE

DAVIE & BIDWELL STREET
VANCOUVER, BC

HIGHLIGHTS

- Corner unit with excellent exposure to Davie Street and Bidwell Street
- West End is comprised of approx. 44,933 residents, 734 businesses and 6,954 employees
- Expansive ceiling heights
- 5,100 SF fully fixtured retail premises

THE OPPORTUNITY

The West End is a vibrant, diverse, walkable, and densely populated community surrounded by world-class parks and beaches, as well as Vancouver's downtown and Central Business District.

Shopping, dining and entertainment is an important part of the West End culture and can be found along Robson Street, Alberni Street, Davie Village and finally both Denman Street and Lower Davie.

LOADING

Dock level commercial bay

PARKING

7 commercial stalls (paid parking)

CEILING HEIGHTS

Minimum 15' throughout

SUSTAINABILITY

Built to LEED Gold standard

TOTAL RESIDENTIAL UNITS

134 (49 rental and 85 strata suites)

TIMING

Immediate

TRAFFIC COUNTS

11,362 VPD

Davie Street Pedestrian Counts

1700 Block of Davie - 3,712 average per day

OPERATING COSTS (2014 ESTIMATES)

\$17.50 per square foot

AVAILABLE UNITS

Unit	SF
CRU 2	1,035
CRU 3	792
CRU 4&5	5,093

ASKING RATES

Please contact listing agents.



FOR LEASE

DAVIE & BIDWELL STREET
VANCOUVER, BC

SITE PLAN

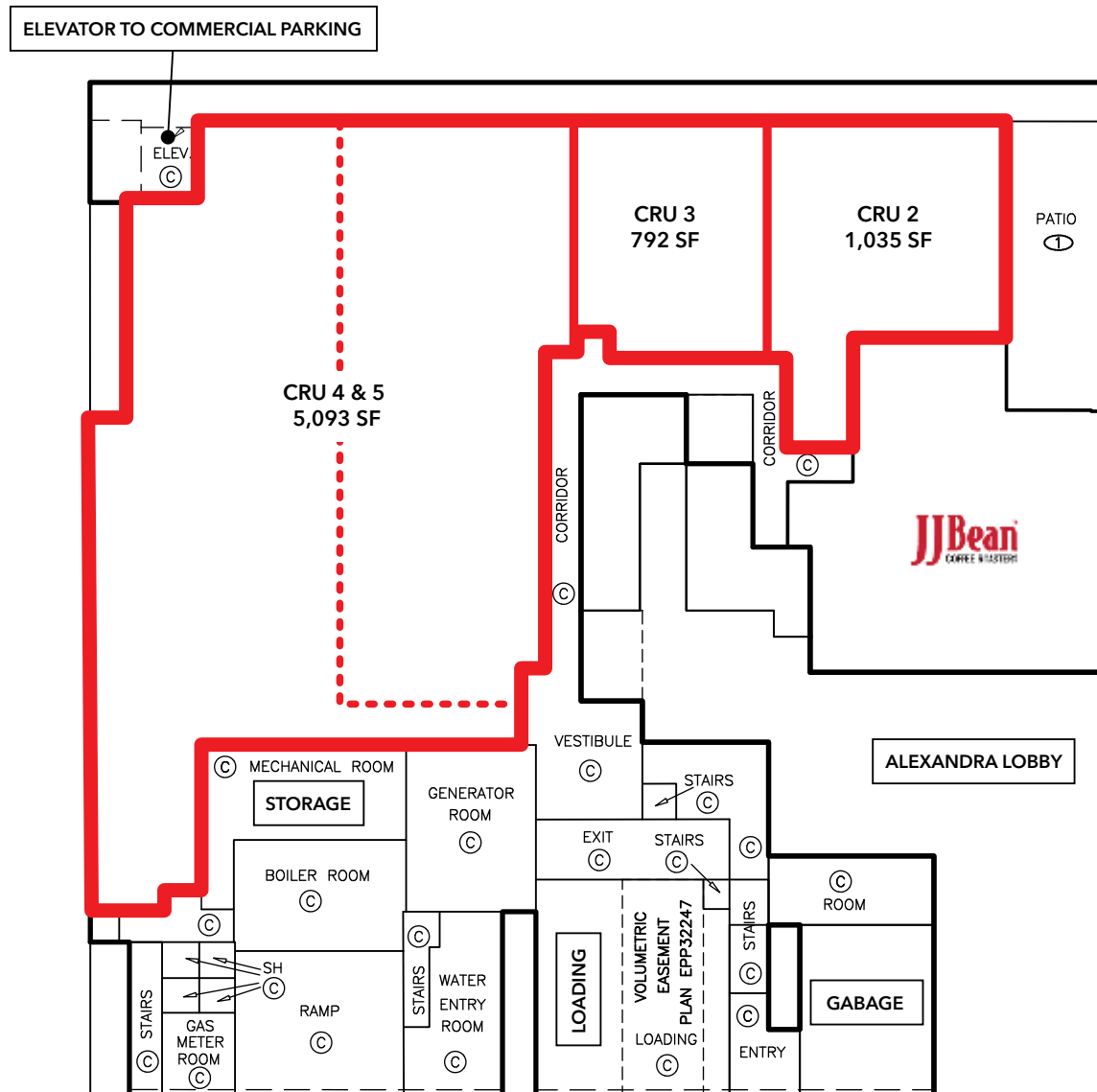

FOR LEASE

ALEXANDRA
DAVIE & BIDWELL STREET
VANCOUVER, BC

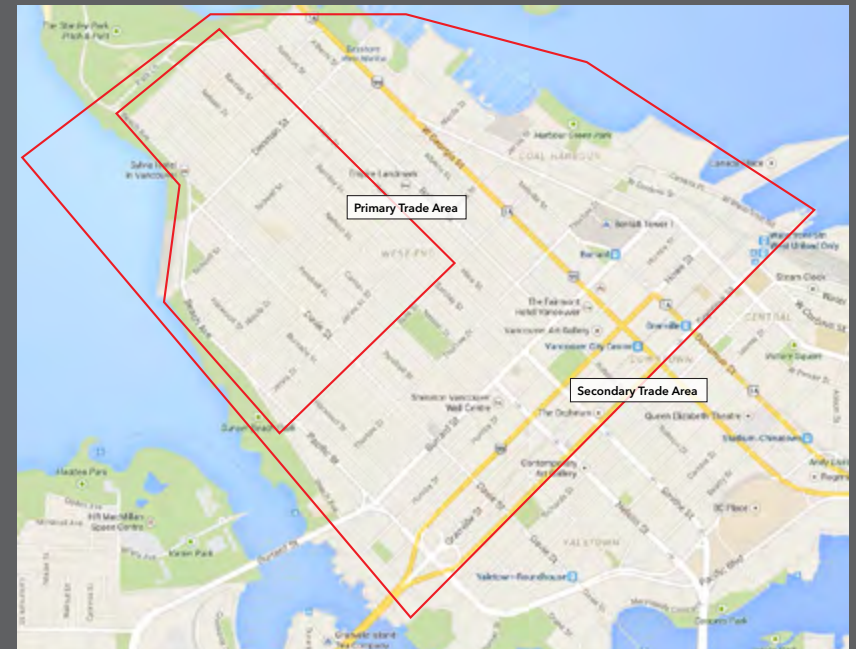

2014 ESTIMATES & PROJECTIONS	PRIMARY TRADE AREA	SECONDARY TRADE AREA
Population	25,393	63,961
Households	17,512	41,038
Average Household Income	\$55,631	\$62,747

FORM RETAIL ADVISORS INC.
1280-333 SEYMOUR STREET
VANCOUVER, BC V6B 5A6

T 604 638 2121 F 604 638 2122
FORMRETAIL.CA

The information contained herein was obtained from sources which we deem reliable and while thought to be correct, are not guaranteed by Form Retail Advisors inc.